



Passacordoni > base

## PASSACORDONI CON BASE DI APPOGGIO IN GOMMA, IN NEOPRENE, IN EPDM, IN PVC, IN TPE



**Materiale:** gomma, nitrile, neoprene, EPDM, PVC serie "KLASSIC", PVC serie "PLIO", TPE senza alogeni.

**Colore:** nero.

**Temperatura d'uso:** -30°C / +90°C (gomma), -25°C / +100°C (nitrile), -30°C / +90°C (neoprene), -25°C / +100°C (EPDM), -25°C / +60°C (PVC serie "KLASSIC"), -30°C / +70°C (PVC serie "PLIO"), -50°C / +125°C (TPE senza alogeni), -40°C / +70°C (TPE 40 ShA senza alogeni)

**Infiammabilità:** antifiama UL94-HB per il PVC serie "PLIO" e il TPE, antifiama e autoestinguente per il PVC serie "KLASSIC".

**Caratteristiche:** GOMMA: questi passacordoni hanno una media resistenza agli oli minerali ed all'acqua.

NEOPRENE, EPDM E NITRILE: questi passacordoni hanno una buona tenuta al calore, non si rompono alle basse temperature, hanno una buona resistenza ai grassi, alle benzine, ai solventi organici ed all'ozono; hanno una discreta resistenza agli oli ed un'ottima resistenza all'invecchiamento. Sono dotati di straordinaria flessibilità e di buone proprietà elettriche.

PVC SERIE "PLIO": questi passacordoni hanno una buona tenuta alle basse ed alte temperature, una buona resistenza all'acqua, agli acidi diluiti, alle soluzioni alcaline, ai sali, all'ozono ed ai raggi UV; hanno una discreta resistenza ai chetoni, agli oli minerali, alle benzine, agli esteri ed un'ottima resistenza all'invecchiamento. Sono dotati di grande morbidezza e di ottime proprietà dielettriche. L'esecuzione particolarmente curata e la superficie perfettamente liscia e brillante offrono la possibilità di utilizzare i nostri passacordoni su qualsiasi apparecchiatura.

PVC SERIE "KLASSIC": questi passacordoni hanno una buona resistenza agli acidi ed agli oli minerali.

TPE: il TPE è un elastomero termoplastico dotato di eccellenti caratteristiche. E' simile alla gomma, ma viene generalmente utilizzato al posto del PVC rispetto al quale è più morbido, più elastico ed ha una maggior resistenza alle basse ed alte temperature. I passacordoni in TPE hanno un'ottima tenuta alle basse ed alte temperature, hanno una buona resistenza all'acqua, all'ozono, agli agenti atmosferici, agli acidi, alle soluzioni saline acquose, ai solventi alifatici e clorati ed ai detergenti; hanno una discreta resistenza ai chetoni, agli oli minerali ed alle benzine ed un'ottima resistenza all'invecchiamento. Sono dotati di estrema flessibilità ed elasticità e di buone proprietà elettriche. Inoltre, non contengono alogeni. Il TPE 40 ShA è una miscela ancora più morbida.

**Su richiesta:** per quantità, passacordoni in altri colori ed in silicone.

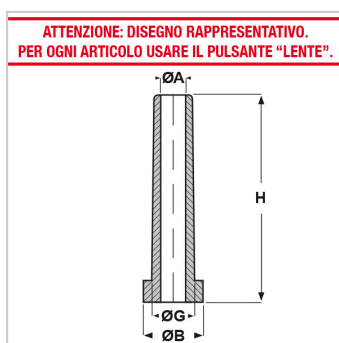

Il disegno è indicativo e le proporzioni potrebbero non corrispondere alle dimensioni in tabella o reali.

ARTICOLO	materiale	ØA mm	ØB mm	ØG mm	H mm	confezione pz.
12-1459 TPE	TPE	7,3	18	13	60	100
12-1460 TPE	TPE	3	8	5	16	100
12-1462 TPE	TPE	5,5	13	9	37	100
12-1466 TPE	TPE	6,2	13	9	37	100
12-1584 TPE	TPE	12	20	15	58	100
12-387 TPE	TPE 40 ShA	2,6	6	4,5	15	100
12-407 TPE	TPE 40 ShA	4	8,4	6,2	23	100
12-552 TPE	TPE	12	20	15	58	100
12-553 TPE	TPE	7,5	11	10	46	100



ARTICOLO	materiale	ØA mm	ØB mm	ØG mm	H mm	confezione pz.
12-598 TPE	TPE	8	16	12	85	100
12-600 TPE	TPE	5,5	13	9	37	100
14-1459	PVC serie "PLIO"	7,3	18	13	60	100
14-1462	PVC serie "PLIO"	5,5	13	9	37	100
14-1466	PVC serie "PLIO"	6,2	13	9	37	100
14-1584	PVC serie "PLIO"	12	20	15	58	100
14-552	PVC serie "PLIO"	12	20	15	58	100
14-553	PVC serie "PLIO"	7,5	11	10	46	100
14-598	PVC serie "PLIO"	8	16	12	85	100
14-600	PVC serie "PLIO"	5,5	13	9	37	100
15-083	neoprene	16	32	25	150	25
15-130	neoprene	8	18,5	15,5	72	50
15-147	neoprene	12	18,5	15,5	72	50
15-320	neoprene	11	32	27	150	25
15-329	EPDM	37	44	-	99,5	25
15-383	neoprene	8,5	15	11,4	50,5	100
15-411*	gomma	7,5	15	12	70	100
15-538	neoprene	6,5	14	10	60	100
15-579	neoprene	7,5	14	10	60	50
15-592	neoprene	8	20	13	69	50
15-596	nitrile	3,5	15,5	7	36	100
15-602	EPDM	7,6	17,5	13,4	90	50
15-625	neoprene	7	16	12	34	100
15-642**	neoprene	8,2	-	11	40	100
15-649	neoprene	4	8	6,2	22	100
15-721	neoprene	3,1	8	6,2	22	100
15-737	neoprene	7,6	17,5	13,4	90	50
15-748	neoprene	14	26	22	80	50
15-756	neoprene	6,6	17,5	13,4	90	50
15-760	neoprene	2,5	8	6,2	22	100
15-781	neoprene	6,6	17,5	13,3	90	50
15-806	neoprene	8	17,5	13,4	90	100
15-832	neoprene	12	16,5	14,75	54,5	100
15-836	neoprene	2,6	6	4,5	15	100
NZ 69	gomma	5	14	11	30	100
NZ 71	gomma	7	14	11	30	100
NZ 72	gomma	6,5	11	10	40	100
NZ 74	gomma	7	15	11	51	100
NZ 76	gomma	9	17	14	64	100
PCG 16-13***	neoprene	13	21	18	56,8	100
PK040	PVC serie "KLASSIC"	8	14	11	21,5	1000
PK041	PVC serie "KLASSIC"	10	15,5	12,5	21,5	1000
QZ 70	gomma	7	14	10	30	100
QZ 73	gomma	6,5	18	12,5	45	100



ARTICOLO	materiale	ØA mm	ØB mm	ØG mm	H mm	confezione pz.
----------	-----------	----------	----------	----------	---------	-------------------

\*Questo passacordone è disponibile anche in neoprene.

\*\*Questo passacordone ha la base quadrangolare.

\*\*\*Articolo con temperatura d'uso: -20°C / +80°C.

N.B.: IL DISEGNO TECNICO ACCANTO ALL'IMMAGINE E' RAPPRESENTATIVO. PER VISUALIZZARE IL DISEGNO TECNICO DI UN SINGOLO ARTICOLO CLICcare SUL PULSANTE "LENTE".

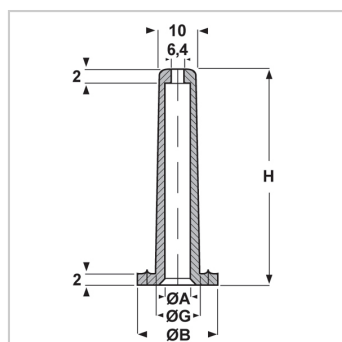

12-1459 TPE

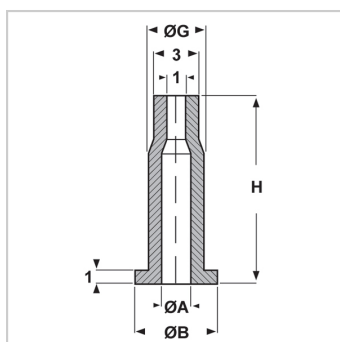

12-1460 TPE

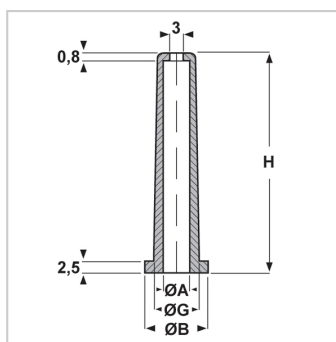

12-1462 TPE

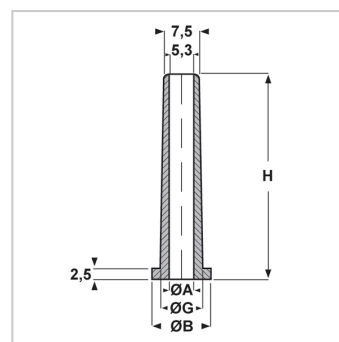

12-1466 TPE

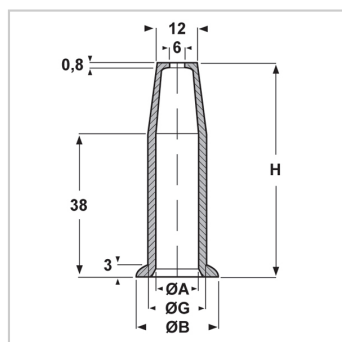

12-1584 TPE

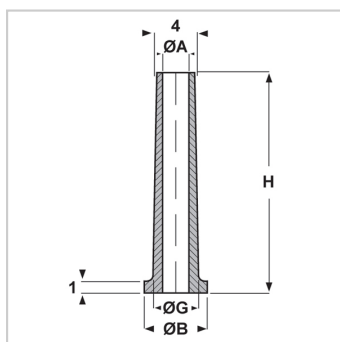

12-387 TPE

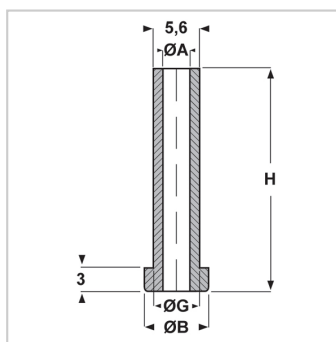

12-407 TPE

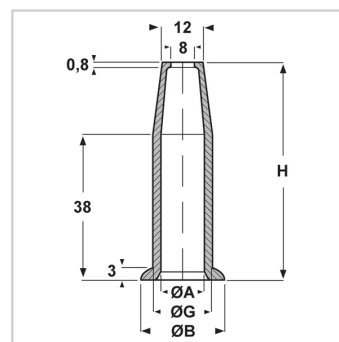

12-552 TPE

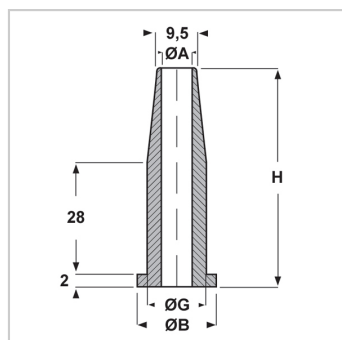

12-553 TPE

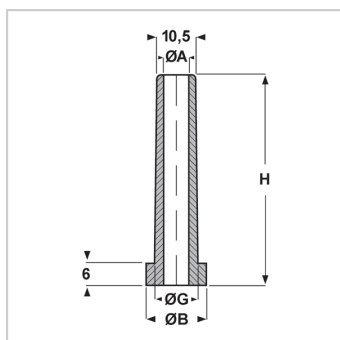

12-598 TPE

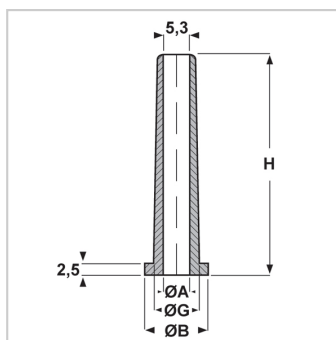

12-600 TPE

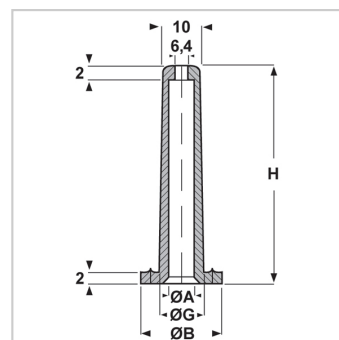

14-1459

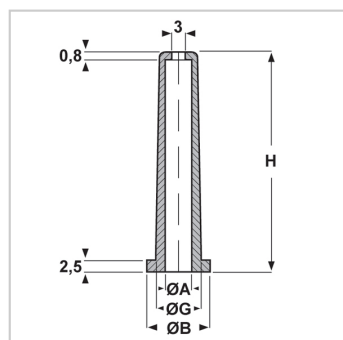

14-1462

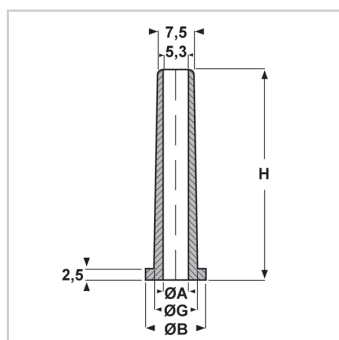

14-1466

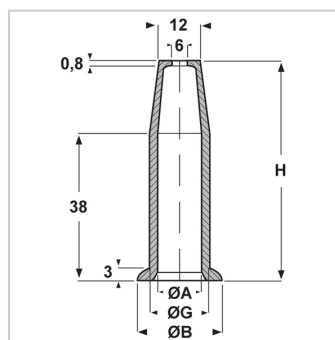

14-1584

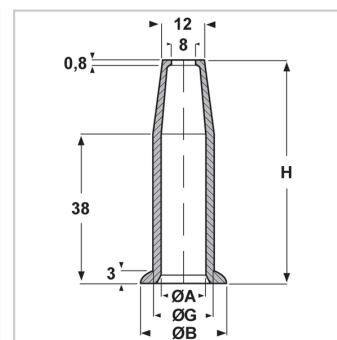

14-552

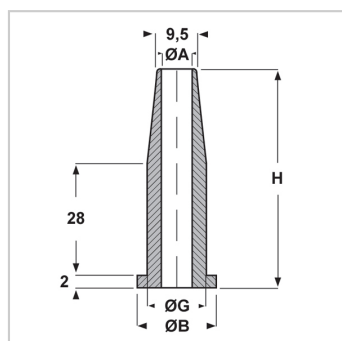

14-553

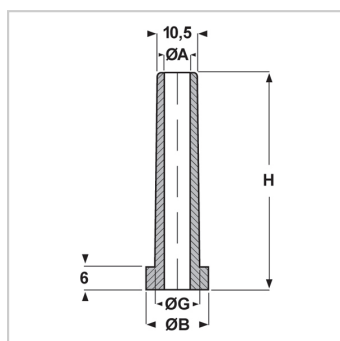

14-598

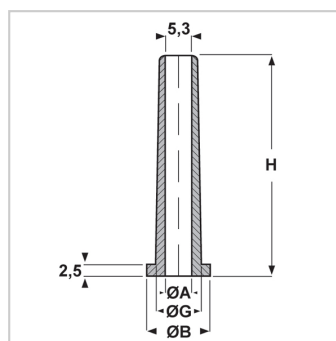

14-600

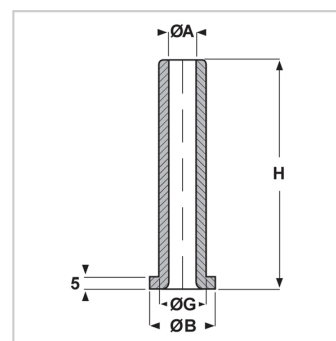

15-083

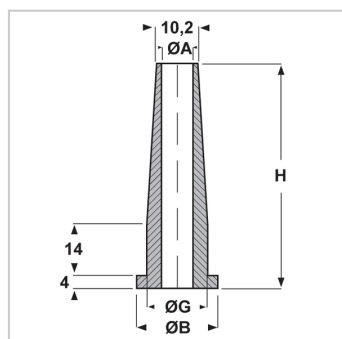

15-130

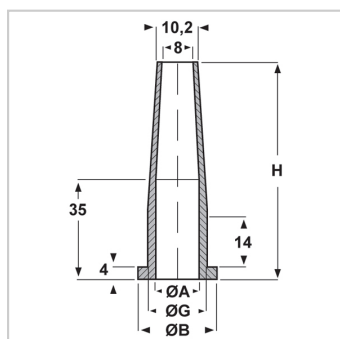

15-147

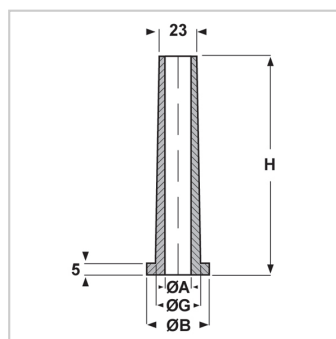

15-320

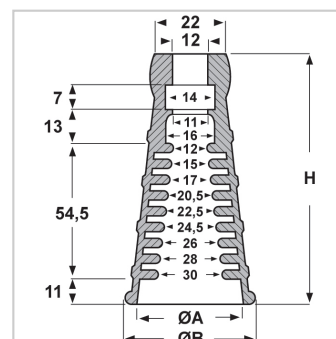

15-329

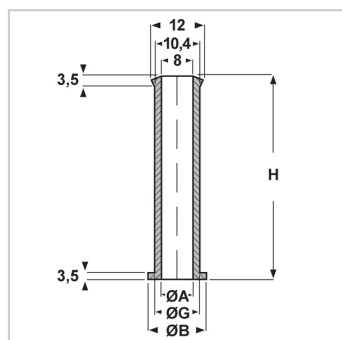

15-383

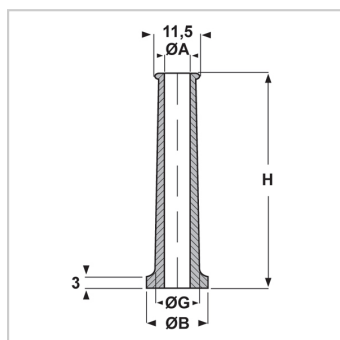

15-411

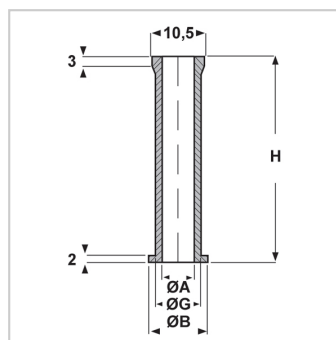

15-538

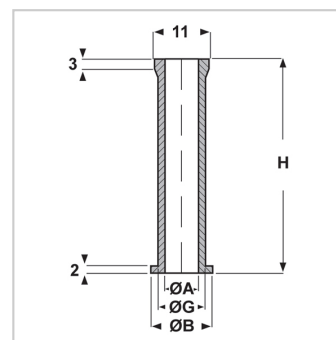

15-579

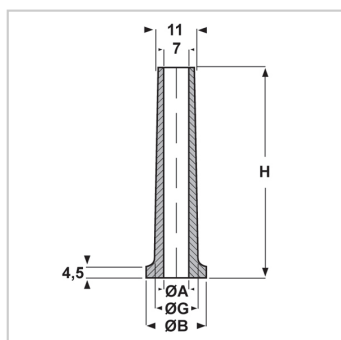

15-592

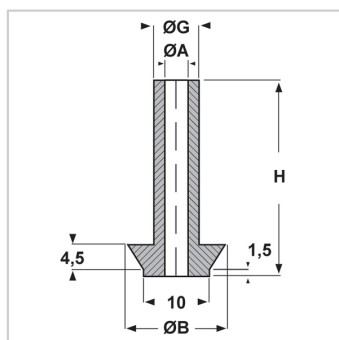

15-596

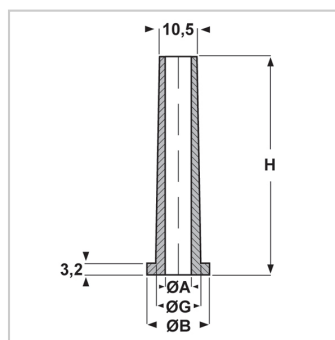

15-602

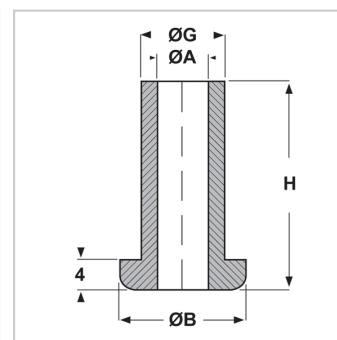

15-625

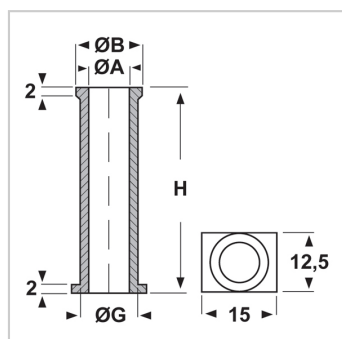

15-642

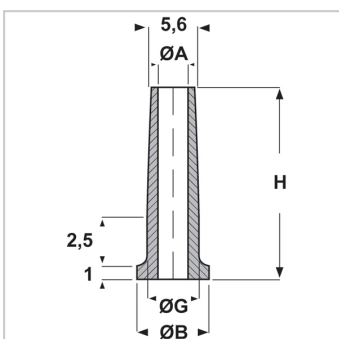

15-649

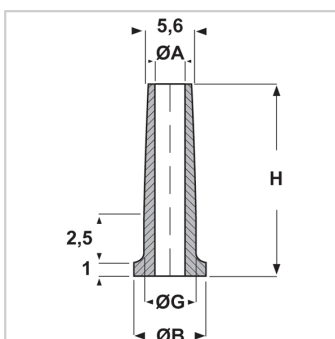

15-721

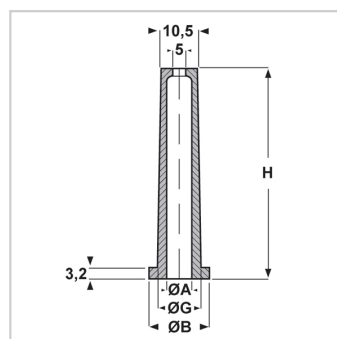

15-737

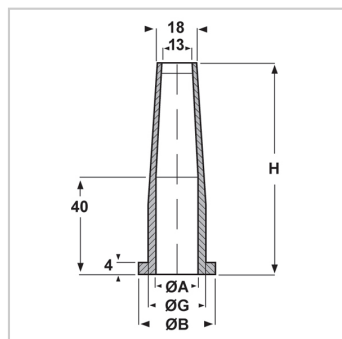

15-748

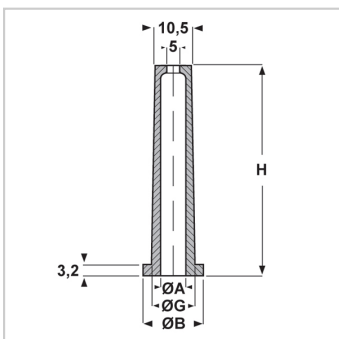

15-756

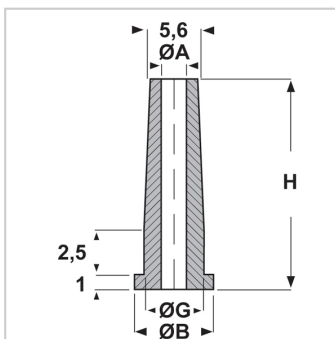

15-760

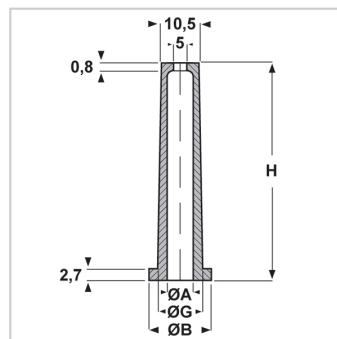

15-781

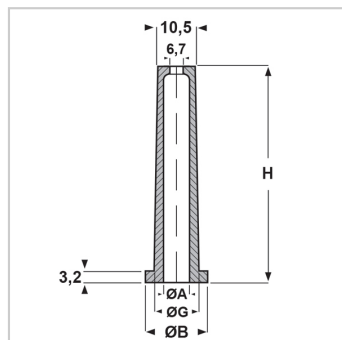

15-806

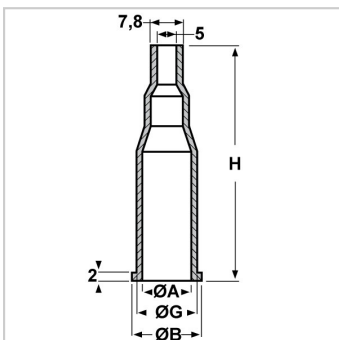

15-832

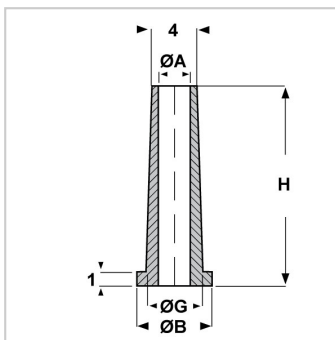

15-836

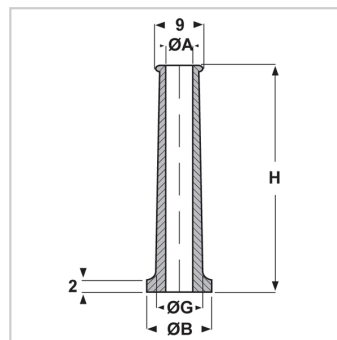

NZ 69

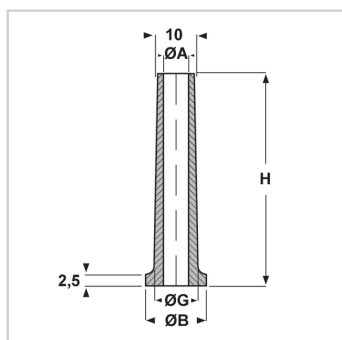

**NZ 71**

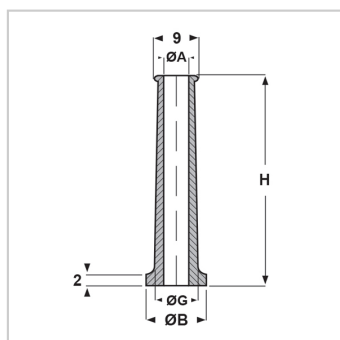

**NZ 72**

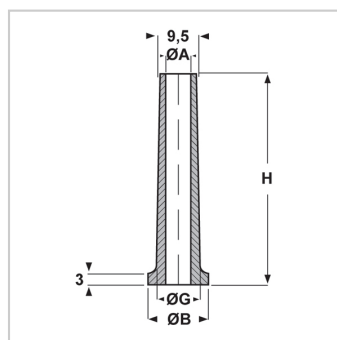

**NZ 74**

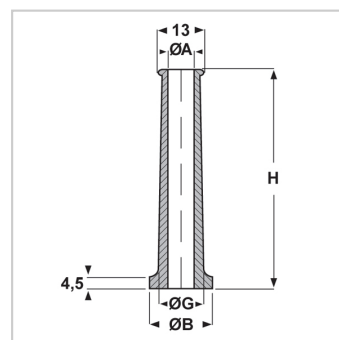

**NZ 76**

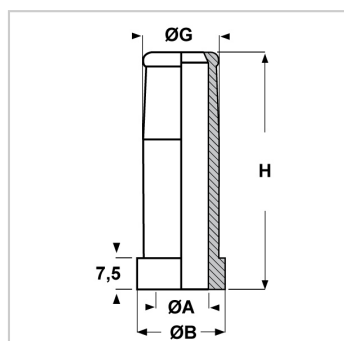

**PCG 16-13**

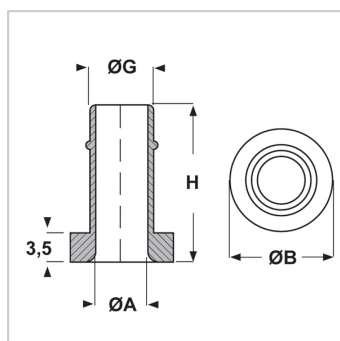

**PK040**

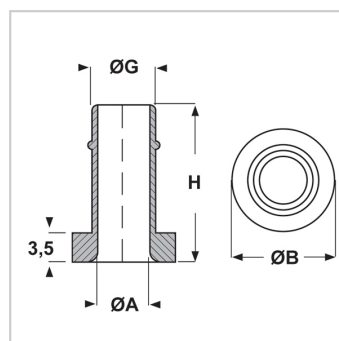

**PK041**

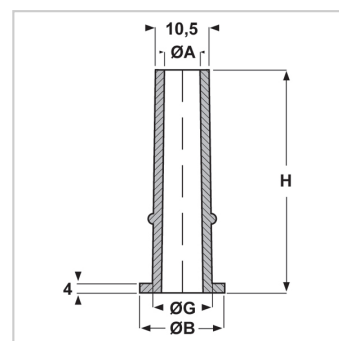

**QZ 70**

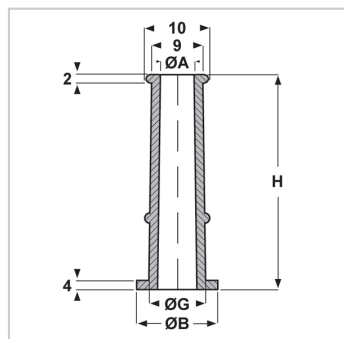

**QZ 73**