



Passacordoni > lisci

PASSACORDONI LISCI IN NEOPRENE E IN PVC

Materiale: neoprene, PVC serie "KLASSIC".

Colore: nero.

Temperatura d'uso: -30°C / +90°C (neoprene), -25°C / +60°C (PVC serie "KLASSIC")

Infiammabilità: antifiama e autoestinguente per il PVC serie "KLASSIC".

Caratteristiche: NEOPRENE: questi passacordoni hanno una buona tenuta al calore, non si rompono alle basse temperature, hanno una buona resistenza ai grassi, alle benzine, ai solventi organici ed all'ozono; hanno una discreta resistenza agli oli ed un'ottima resistenza all'invecchiamento. Sono dotati di straordinaria flessibilità e di buone proprietà elettriche.

PVC SERIE "KLASSIC": questi passacordoni hanno una buona resistenza agli acidi ed agli oli minerali.

Su richiesta: per quantità, passacordoni in altri colori ed in silicone.

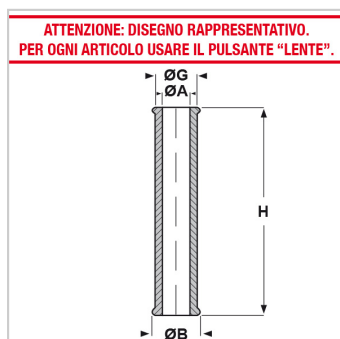

Il disegno è indicativo e le proporzioni potrebbero non corrispondere alle dimensioni in tabella o reali.

| ARTICOLO | materiale | ØA mm | ØB mm | ØG mm | H mm | confezione pz. |
|----------|-----------|----------|----------|----------|---------|-------------------|
| 15-009 | neoprene | 5 | 8,5 | - | 15 | 100 |
| 15-043 | neoprene | 5 | 9 | - | 51 | 100 |
| 15-045 | neoprene | 10 | 14 | - | 60 | 100 |
| 15-060 | neoprene | 16 | 30 | - | 18 | 100 |
| 15-164 | neoprene | 7 | 12,8 | - | 80 | 50 |
| 15-169 | neoprene | 7 | 13,5 | 12 | 95 | 100 |
| 15-170 | neoprene | 7,5 | 13,5 | 12 | 95 | 100 |
| 15-171 | neoprene | 8,2 | 13,5 | 12 | 95 | 100 |
| 15-172 | neoprene | 9,4 | 13,5 | 12 | 95 | 100 |
| 15-190 | neoprene | 2,7 | 4,7 | - | 20 | 100 |
| 15-318 | neoprene | 6,3 | 11 | - | 28 | 100 |
| 15-380 | neoprene | 5 | 9,5 | 7 | 50 | 100 |
| 15-391 | neoprene | 6,2 | 10 | 8,2 | 60 | 100 |
| 15-401 | neoprene | 4,5 | 7 | - | 26 | 100 |
| 15-402 | neoprene | 5 | 9,5 | - | 23 | 100 |
| 15-403 | neoprene | 5,2 | 9 | - | 18 | 100 |
| 15-405 | neoprene | 5 | 9 | - | 30 | 100 |
| 15-653 | neoprene | 10 | 20 | - | 20 | 100 |
| 15-654 | neoprene | 12 | 20 | - | 20 | 100 |
| 15-680 | neoprene | 4 | 8 | - | 40 | 100 |
| 15-833 | neoprene | 4,3 | 8,3 | - | 40 | 100 |
| 15-834 | neoprene | 2,9 | 7 | - | 40 | 100 |



| ARTICOLO | materiale | ØA mm | ØB mm | ØG mm | H mm | confezione pz. |
|----------|------------------------|----------|----------|----------|---------|-------------------|
| PK050 | PVC serie "KLASSIC" | 5 | 9,5 | 8 | 31 | 1000 |

N.B.: IL DISEGNO TECNICO ACCANTO ALL'IMMAGINE E' RAPPRESENTATIVO. PER VISUALIZZARE IL DISEGNO TECNICO DI UN SINGOLO ARTICOLO CLICCARE SUL PULSANTE "LENTE".

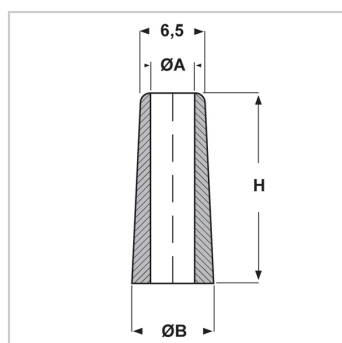

15-009

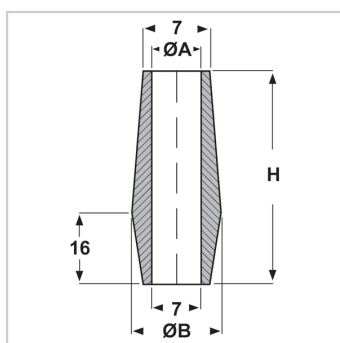

15-043

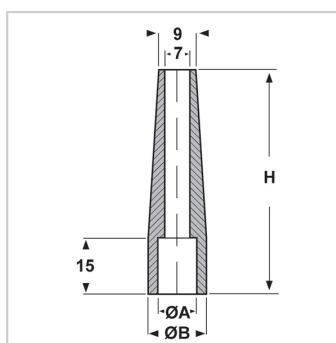

15-045

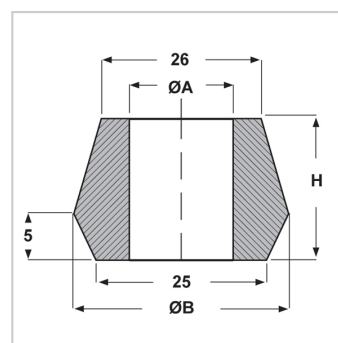

15-060

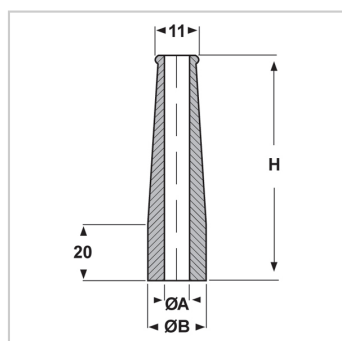

15-164

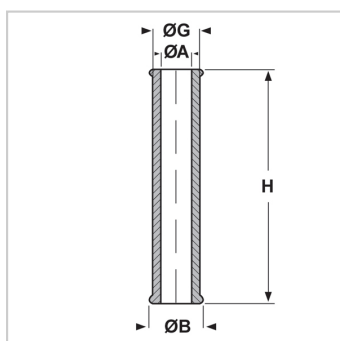

15-169

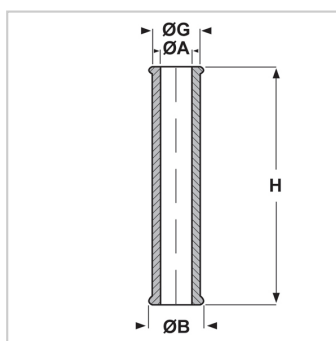

15-170

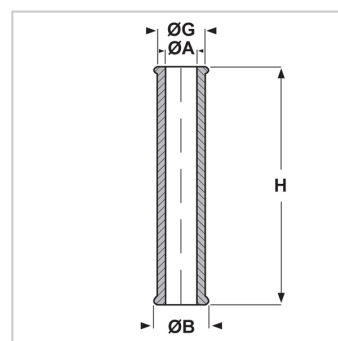

15-171

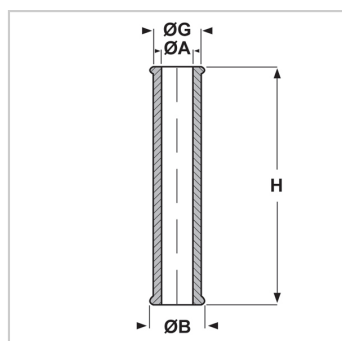

15-172

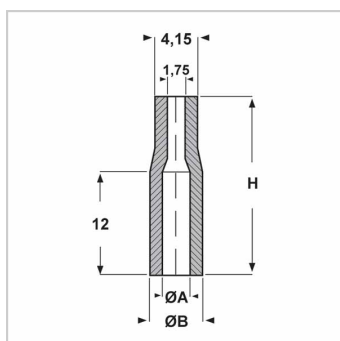

15-190

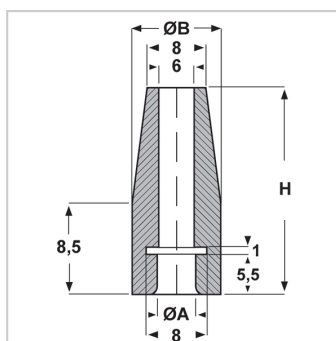

15-318

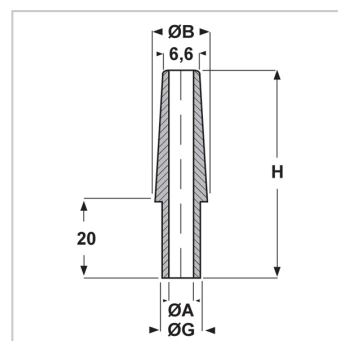

15-380

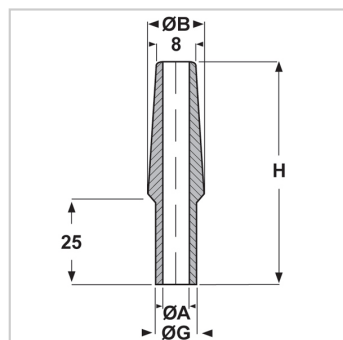

15-391

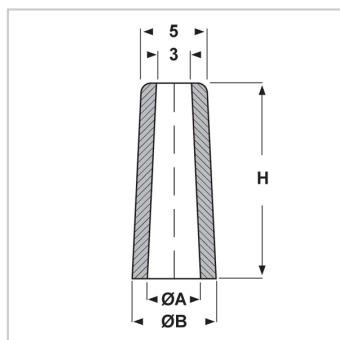

15-401

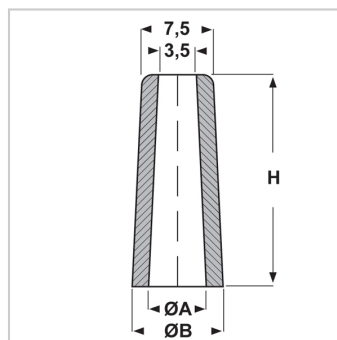

15-402

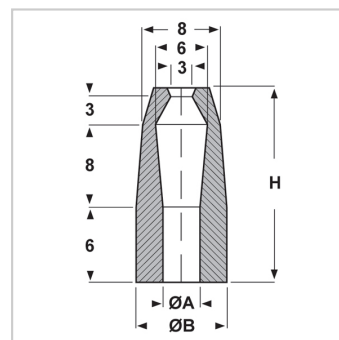

15-403

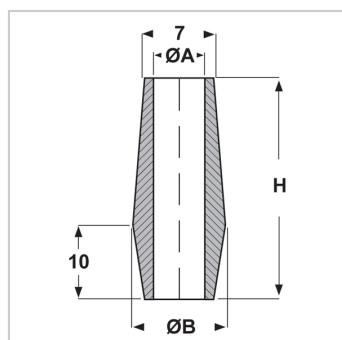

15-405

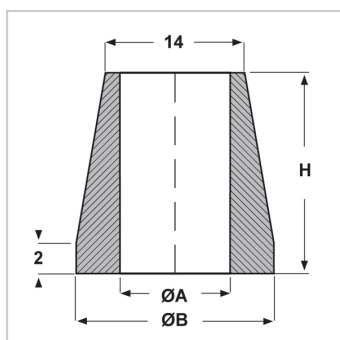

15-653

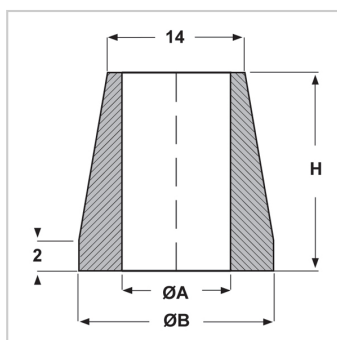

15-654

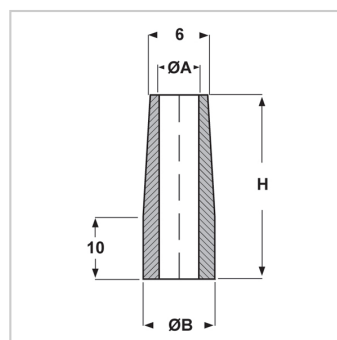

15-680

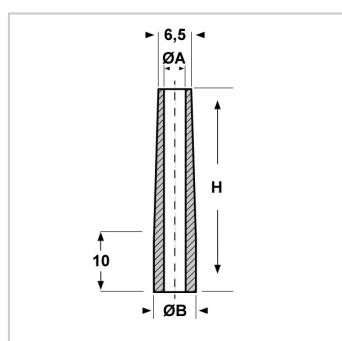

15-833

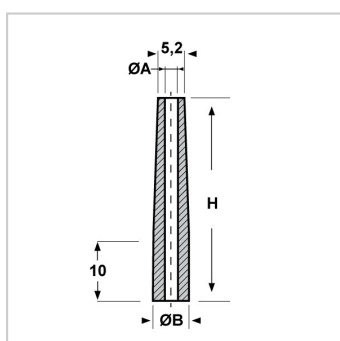

15-834

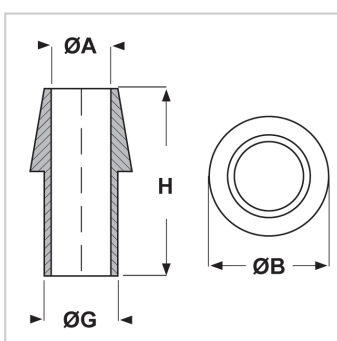

PK050