



Piedini > a pressione > PVC, serie EZ > PAS

PIEDINI IN PVC - SERIE "EZ" -

Materiale: PVC.

Colore: nero, naturale, grigio.

Caratteristiche: questi piedini presentano un'ottima finitura ed hanno un'ottima resistenza.

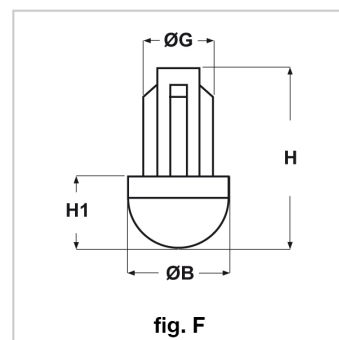
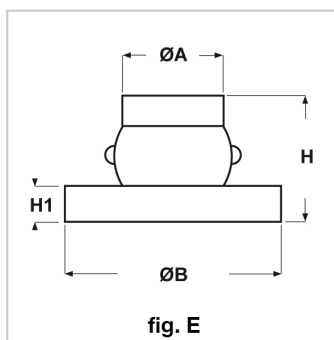
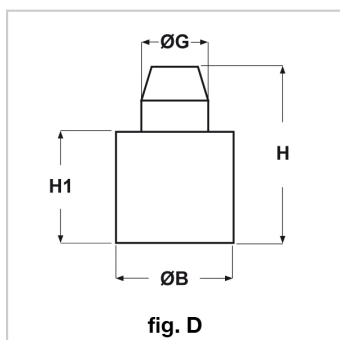
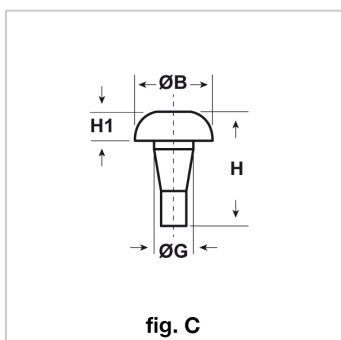
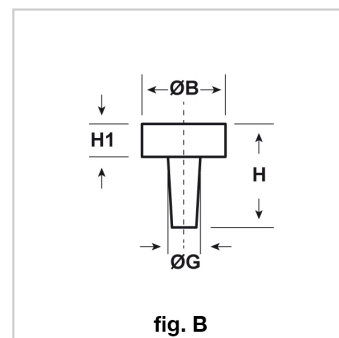
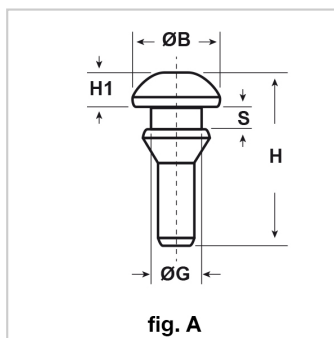

Il disegno è indicativo e le proporzioni potrebbero non corrispondere alle dimensioni in tabella o reali.

| ARTICOLO | colore | specifica | ØB mm | ØG mm | H mm | H1 mm | S mm | confezione pz. |
|------------|----------|-----------|----------|----------|---------|----------|---------|-------------------|
| PAS 10 | naturale | fig. C | 9 | 4,2 | 13 | 3,5 | - | 1000 |
| PAS 10-12* | grigio | fig. D | 10 | 4,7 | 12 | 7 | - | 1000 |
| PAS 12 | nero | fig. B | 12 | 4 | 10 | 3 | - | 1000 |
| PAS 13 | nero | fig. B | 13 | 5 | 13 | 3 | - | 1000 |
| PAS 16 | nero | fig. B | 16 | 5 | 10 | 4 | - | 1000 |
| PAS 16-9 | naturale | fig. E | 16 | 8 | 9 | 3 | - | 1000 |
| PAS 6 | nero | fig. A | 10 | 6 | 19,5 | 4 | 2,5 | 1000 |
| PAS 8 | nero | fig. B | 8 | 3 | 10 | 3 | - | 1000 |
| PAS 9,5 | nero | fig. F | 9,5 | 6,8 | 16,5 | 6,5 | - | 1000 |

*Piedino grigio in polietilene PE-LD.